

# EMI SOLUTIONS PVT. LTD.

*Total solution to EMI*

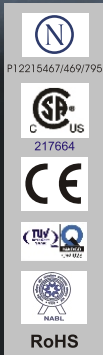

## EMI/RFI FEEDTHROUGH CAPACITORS & FILTERS



**WORLD CLASS PRODUCTS.  
WORLD WIDE ACCEPTANCE.**

**EMI SOLUTIONS PVT. LTD.**

E-mail : [marketing@emisindia.com](mailto:marketing@emisindia.com)  
Website : [www.emisindia.com](http://www.emisindia.com)

**INNOVATIVE DESIGNS.  
IMPECCABLE QUALITY.**



## FEEDTHROUGH CAPACITORS / FILTERS

**EMI Solutions Pvt. Ltd.**, launches a new Range of Feedthrough Capacitors and Feedthrough Filters which are used for suppressing EMI noise in various applications.

The Feedthrough by EMIS provides High insertion Loss (attenuation) to the wide range of frequency upto 1 GHz. The Feedthrough Capacitors and Feedthrough Filters are in compliance with Standard CAN / CSA-E60384-14:09.

EMIS has a wide range of standard Feedthrough Capacitors and Filters. The Feedthrough Capacitors and Filters are supplied with various configurations like C, L,  $\pi$  and T with various mounting and terminations. The Feedthroughs are available up to 600A in both AC and DC.

EMIS also provides Feedthrough Filters and Capacitors in Multiline Configuration (two lines, three lines and four lines). It is also available with Surge Suppressor.

EMIS also develops customised Feedthrough based on the configuration, Capacitor rating, Electrical Parameters / Characteristics, Mechanical Dimensions and Mounting arrangements of the Customer.

### Applications:

- **Telecommunications**
- **Shielded Rooms**
- **Medical Equipments**
- **Electrical / Electronics Equipments**
- **Automation / Machineries**
- **Renewable Energy Plants, etc.**





### Features

- **Compact in Size**
- **Very wide range with Different Mounting**
- **Very High Insertion Loss**
- **Custom built components are available based on customer specification**

### Mechanical Details

- **Brass Enclosure with Nickel Plating**
- **Paint (Optional)**
- **Insulator UL94 V-O**

### Terminations

- **Threaded Brass Bolts**
- **Soldering Terminals (On request)**
- **Up to 25A (M4) Up to 75A (M6),**
- **Up to 100A (M8), Up to 200A (M10),**
- **Up to 400A (M12), Up to 600A (M16)**

### Threads

- **M12 x 1**
- **M16 x 1**
- **M20 x 1**
- **M27 x 1.5**
- **M32 x 1.5**

### Configurations

- **C, L,  $\pi$  and T**
- **Multi Line**

*EMIS-WW-XXX-YYY-ZZ*

*WW: Type (C-FTC, L-FTL,-FTF) - XXX : Current Rating - YYY : Voltage Rating, ZZ - Capacitance / Inductance*



## AC Feedthrough Capacitors / Filters

Low Current Feedthrough (Model - 1)

- Up to 20A
- 250VAC / 600 VDC
- 0.1 $\mu$ F to 0.5  $\mu$ F

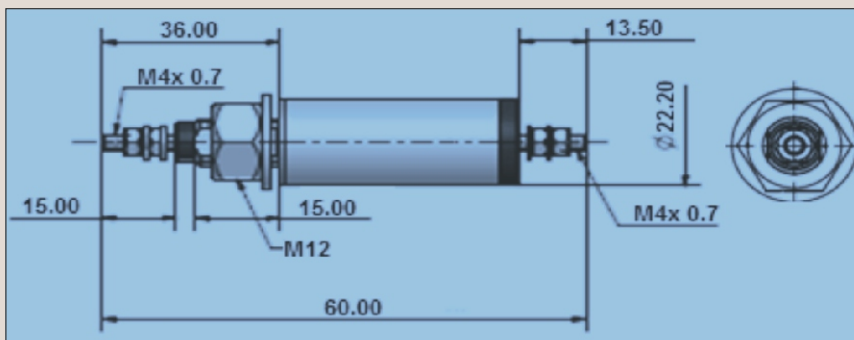

TYPE : C

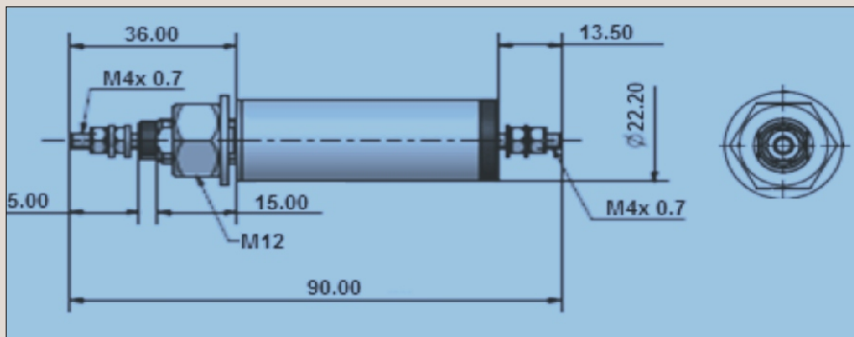

TYPE : L

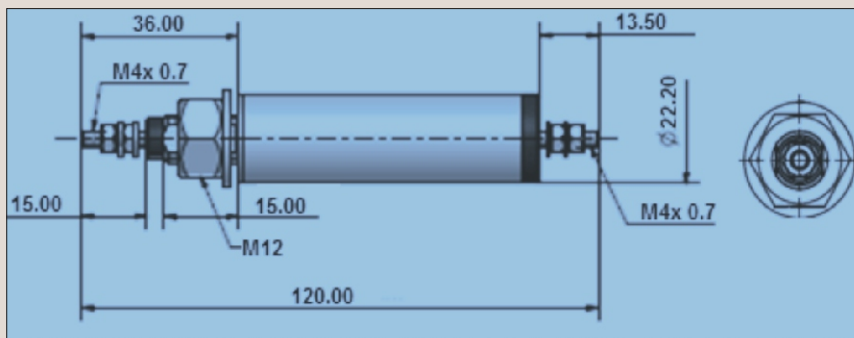

TYPE :  $\pi$



## AC Feedthrough Capacitors / Filters

Low Current Feedthrough (Model - 2)

- Up to 20A
- 250VAC / 600VDC
- 0.1 $\mu$ F to 1.5  $\mu$ F

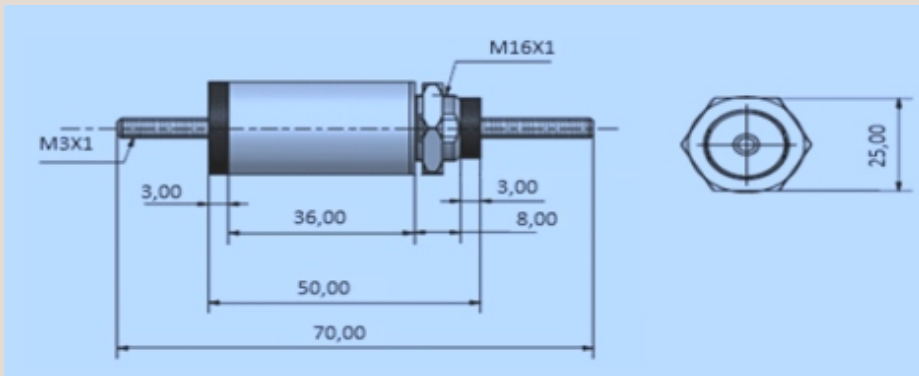

TYPE : C

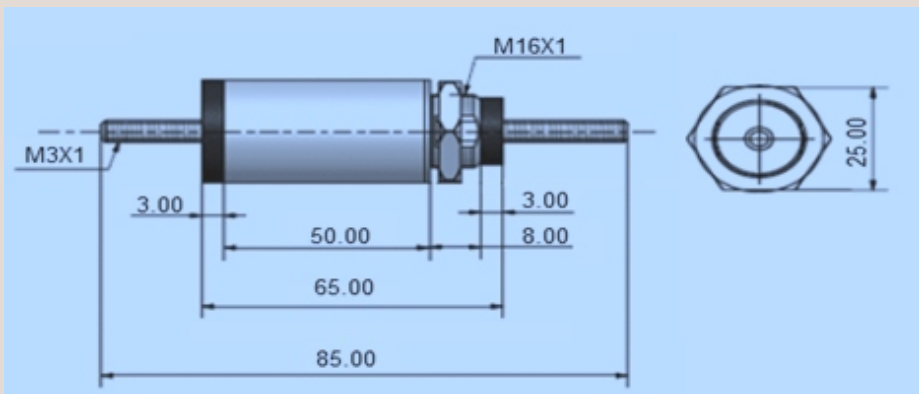

TYPE : L

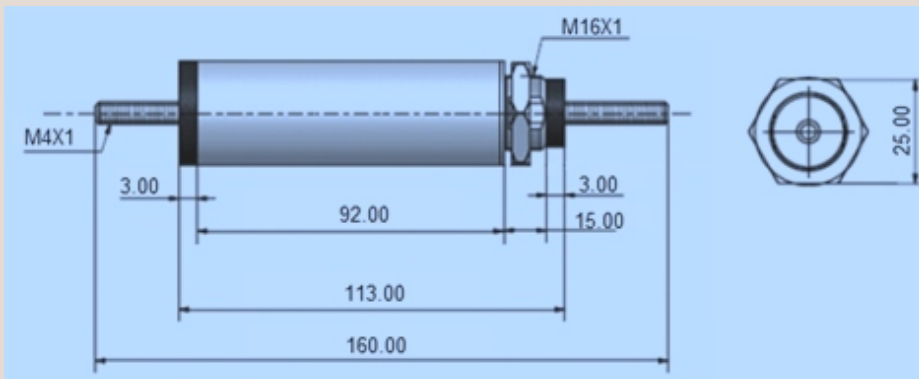

TYPE : π



## AC Feedthrough Capacitors / Filters

Medium Current Feedthrough (Model - 1)

- Up to 100A
- 250VAC / 600VDC
- 0.1 $\mu$ F to 0.5  $\mu$ F

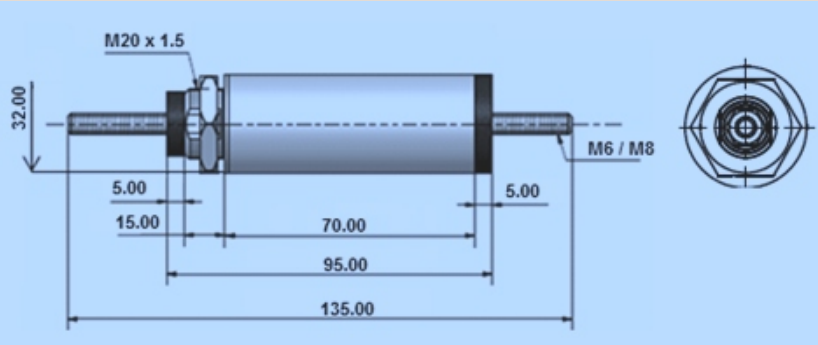

TYPE : C

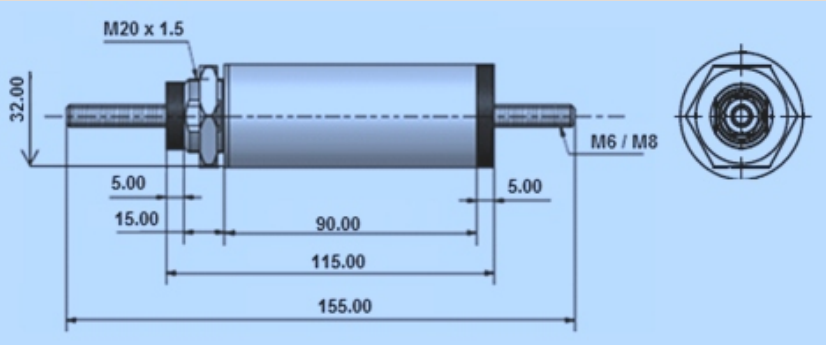

TYPE : L

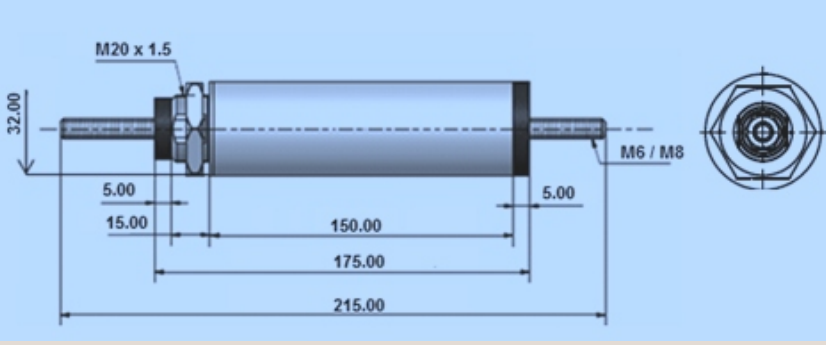

TYPE :  $\pi$



## AC Feedthrough Capacitors / Filters

Medium Current Feedthrough (Model - 2)

- Up to 100A
- 250VAC / 600VDC
- 0.1 $\mu$ F to 10  $\mu$ F

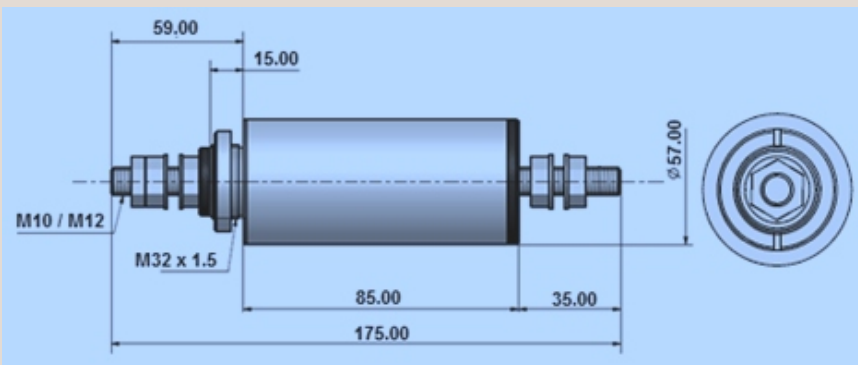

TYPE : C

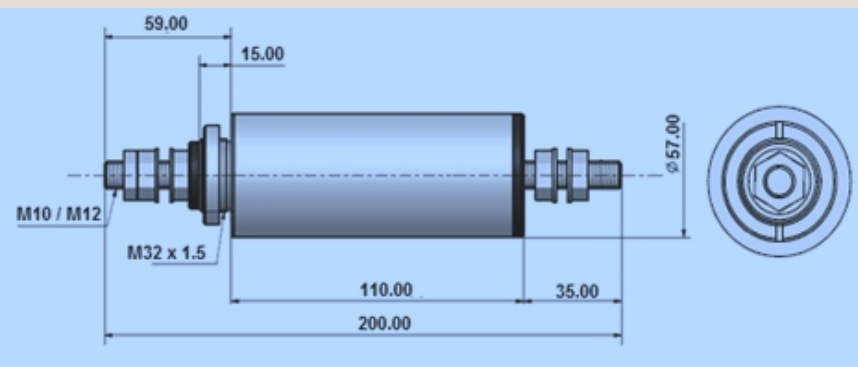

TYPE : L

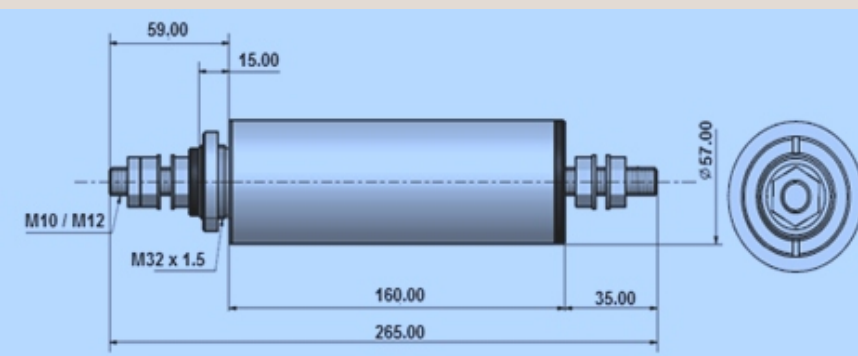

TYPE : π



## AC Feedthrough Capacitors / Filters

High Current Feedthrough (Model - 1)

- Up to 400A
- 250VAC / 600VDC
- 0.1 $\mu$ F to 10  $\mu$ F

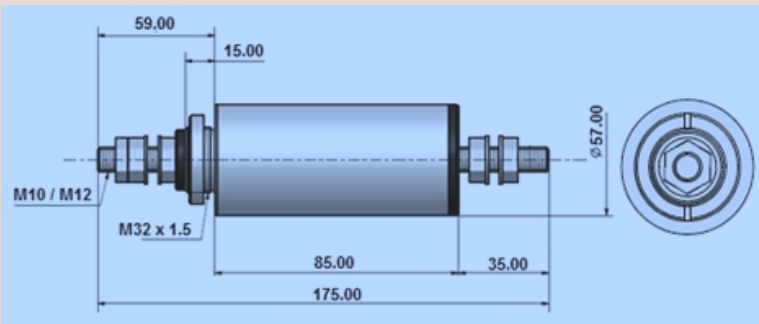

TYPE : C

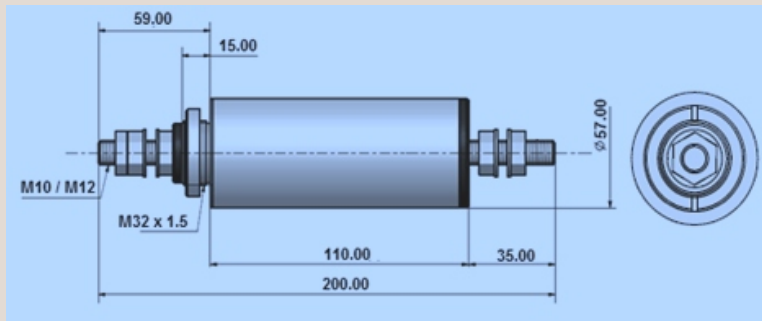

TYPE : L

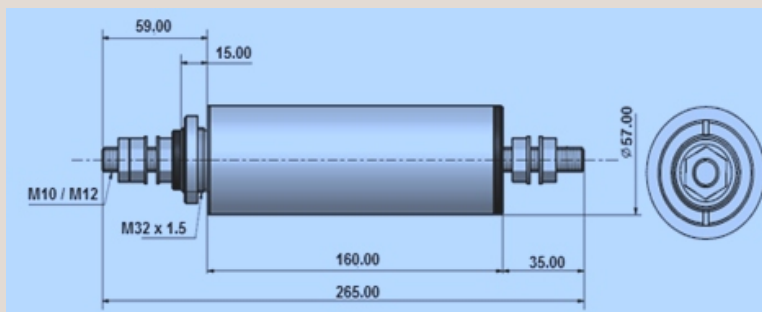

TYPE : π



## AC Feedthrough Capacitors / Filters

High Current Feedthrough (Model - 2)

- Up to 600A
- 250VAC / 600VDC
- 1  $\mu$ F to 20  $\mu$ F

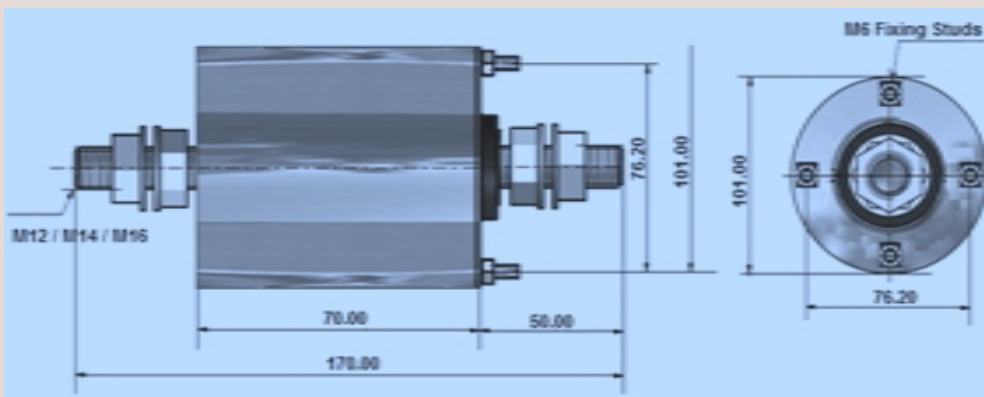

TYPE : C

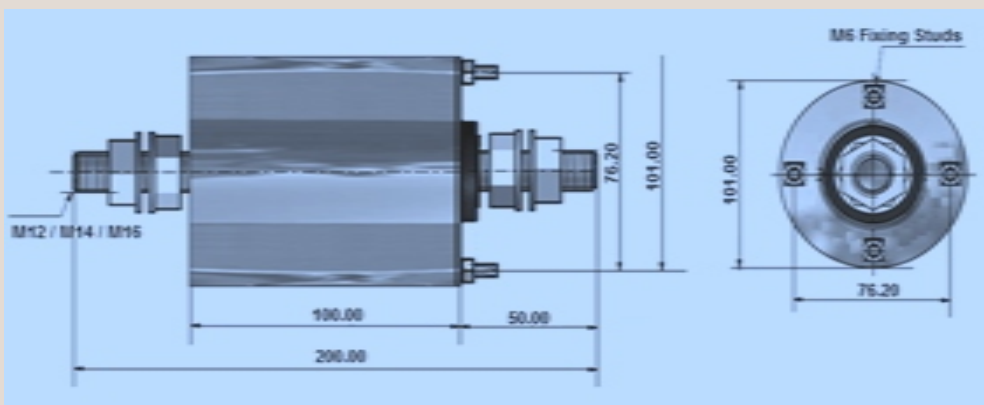

TYPE : L



## AC Multi line Feedthrough Capacitors

- Up to 100A
- 250VAC / 600VDC
- 1  $\mu$ F to 5  $\mu$ F

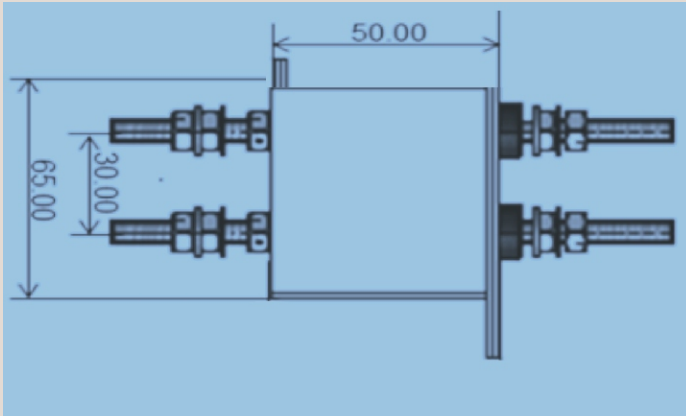

2 LINES

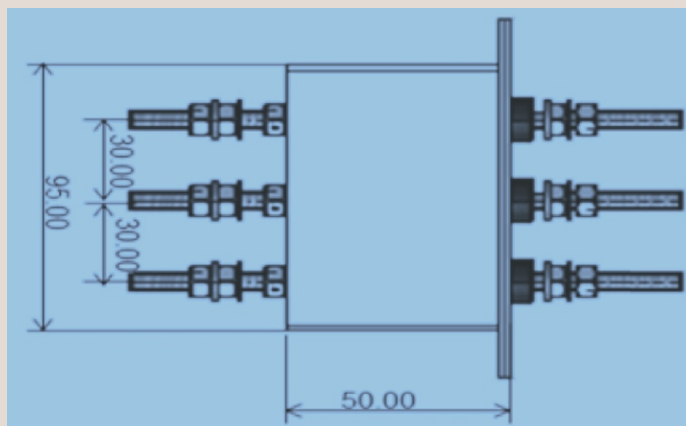

3 LINES

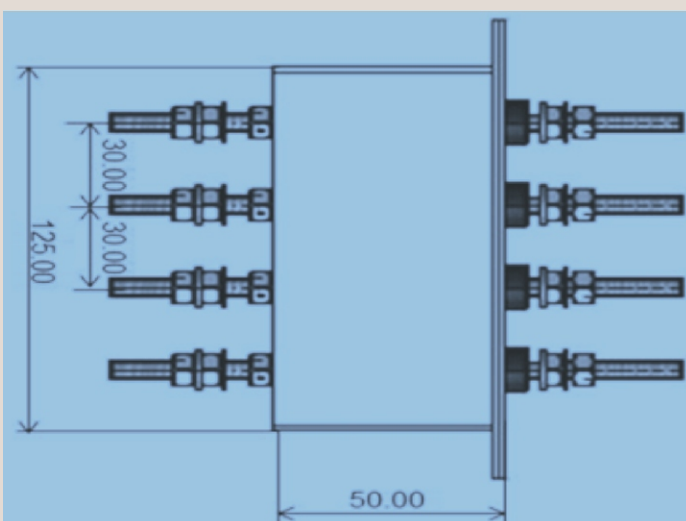

4 LINES

***ALSO AVAILABLE WITH  
SURGE SUPPRESSOR***



## Custom Built AC Feedthrough Capacitors

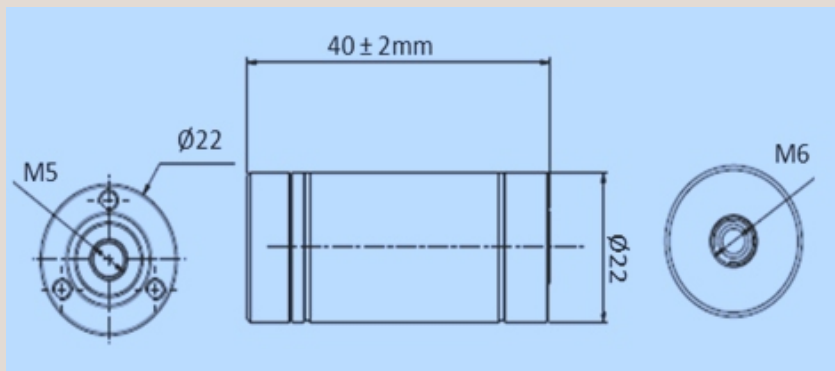

- Upto 100A
- 250VAC / 600VDC
- 1  $\mu$ F

*Size may vary for the Higher Ratings*

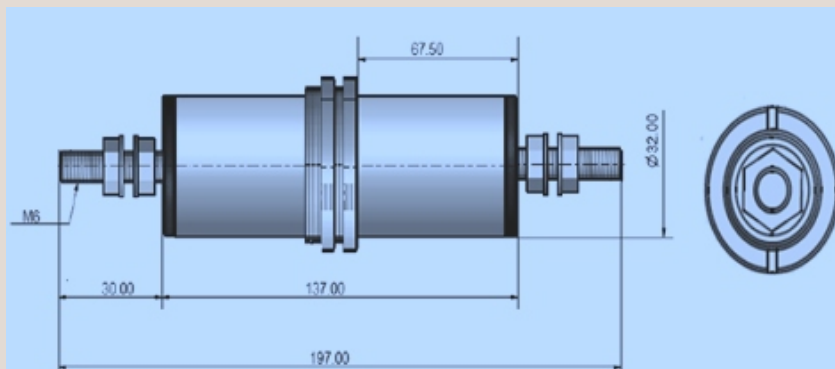

- Upto 100A
- 250VAC / 600VDC
- 1  $\mu$ F to 5  $\mu$ F

# APPLICATIONS



our corporate philosophy **Perfection** our corporate philosophy



**Perfection**

For more details please contact :

## EMI SOLUTIONS PVT. LTD.

# 237 A-5, Bommasandra Industrial Area,  
Hosur Road,  
Bangalore 560 099, India  
Ph : + 91-80-27836837 / 838 / 839  
Fax: + 91-80-27836880

E-mail : [marketing@emisindia.com](mailto:marketing@emisindia.com)  
website: [www.emisindia.com](http://www.emisindia.com)



**INNOVATIVE DESIGNS.  
IMPECCABLE QUALITY.**

DISCLAIMER: The images / specifications in the catalogue are only indicative, the actual product may differ. The company reserves all rights to change the above as required

Aug 2014